

1

2

3

4

5

## REVISION TABLE

REV	ECN#	DESCRIPTION	REV BY	APPROVED	DATE
---	---	Original Drawing	JRM	MPW	10-8-20

2X 2-56 UNC THRU

Lead Wires (2) 6 -9 inches long

  
 When + is connected to Red/White and - is connected to Black then the actuator coil will move in the + direction

2-56 UNC  $\nabla$  .172 [4.4]

4X 2-56 UNC THRU ALL

[3.2]  
 $\phi$  .125  
 Internal Shaft

[25.9]  
 $\phi$  1.020

[30]  
 $\phi$  1.180

[11]  
 .433

[19.1]  
 .750

[23.9]  
 $\phi$  .940 BC

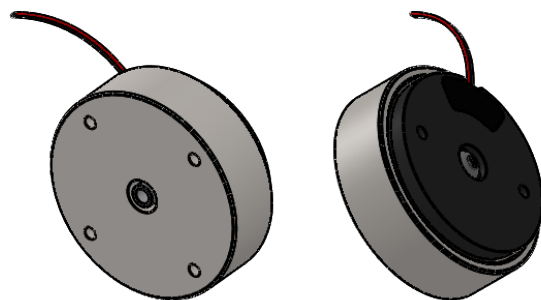
**NOTE: Actuator shown in retracted position**

**H2W Technologies, Inc.**  
 Santa Clarita, CA 91350 USA  
 Tel: (661) 291-1620  
[www.h2wtech.com](http://www.h2wtech.com)

These drawings and specifications are the property of H2W Technologies, Inc. They are issued in confidence and shall not be reproduced, copied, or used without written permission from H2W Technologies, Inc.

UNLESS SPECIFIED OTHERWISE:  
 All dimensions are in inches  
 Standard Tolerances are as follows  
 .XXX  $\pm$  .005 ANGLES  $\pm$  1°  
 .XX  $\pm$  .010 FILLETS .010  
 .X  $\pm$  .020 CORNERS .010  
 Remove All Burrs and Sharp Edges

**FOR  
 REFERENCE  
 ONLY**

MATERIAL

FINISH

TITLE

**NCC01-12-004-1C**  
**Non-Comm DC Linear Actuator**

DWG # **30-1537**

REV

DATE

10-7-20

SHEET

1 of 2

1

2

3

4

5

## NON-COMM ACTUATOR SPECIFICATIONS

Motor P/N	NCC01-12-004-1C	
Device Type	Moving Coil	
Stroke	0.08 in	2.0 mm
Radial Clearance	0.010 in	0.25 mm
Bearing Type	Sliding Contact	
Moving Mass	0.017 lbs	7.5 grams
Total Mass	0.100 lbs	45.5 grams
Resistance @ 20C	0.90 ohms	
Inductance @ 20C	0.45 mH	
Electrical Time Constant	0.5 msec	
Motor Constant	0.18 lbs/sqrt(watt)	0.8 N/sqrt(watt)
Force Constant	0.17 lbs/amp	0.8 N/amp
Back EMF	0.02 V/ips	0.8 V/m/sec
Force @ 100% Duty	0.45 lbs	2 N
Power @ 100% Duty	6 watts	
Current @ 100% Duty	2.6 amps	
Force @ 10% Duty	1.35 lbs	6 N
Power @ 10% Duty	56 watts	
Current @ 10% Duty	7.8 amps	

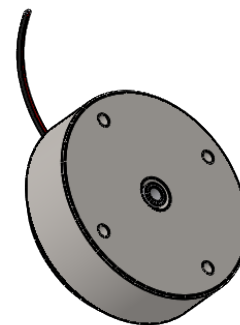
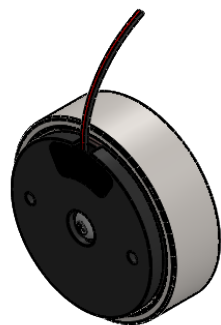

**H2W Technologies, Inc.**  
 Santa Clarita, CA 91350 USA  
 Tel: (661) 291-1620  
[www.h2wtech.com](http://www.h2wtech.com)

These drawings and specifications are the property of H2W Technologies, Inc. They are issued in confidence and shall not be reproduced, copied, or used without written permission from H2W Technologies, Inc.

UNLESS SPECIFIED OTHERWISE:  
 All dimensions are in inches  
 Standard Tolerances are as follows  
 .XXX ±.005 ANGLES ±.1°  
 .XX ±.010 FILLETS .010  
 .X ±.020 CORNERS .010  
 Remove All Burrs and Sharp Edges

**FOR  
 REFERENCE  
 ONLY**

MATERIAL

FINISH

TITLE

**NCC01-12-004-1C  
 Specifications**

DWG #

**30-1537**

REV

----

DATE

10-8-20

SHEET

2 of 2